



Industrial Thermal Printer



CL4NX™

SATO, Beyond Expectation

SATO's first truly UNIVERSAL Industrial Label Printer engineered for the most demanding printing applications

Simple-to-Operate

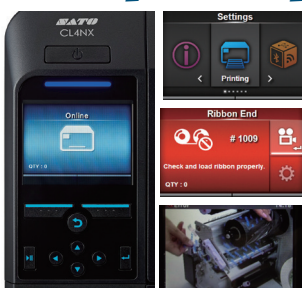

- Full Color Interactive LCD
- Videos that Offer Valuable Information on the Printer Operation
- Intuitive Menu Navigation
- Tool-less Maintenance

Plug-and-Play



- LTDS (Label Tension Damper System)
- Flexible Media Support - Use Wound In or Wound Out Media
- High Energy Mode - Prints on a Wide Variety of Stock Types

All-in-One



- Multiple Interfaces - Auto Switching
- Competitive Emulations On-board
- Multi-national Language Support

GENERAL SPECIFICATIONS / CL4NX™

PRINT SPECIFICATIONS

Method

Direct Thermal or Thermal Transfer

Resolution

203 dpi (8 dots/mm)	305 dpi (12 dots/mm)	609 dpi (24 dots/mm)
------------------------	-------------------------	-------------------------

Speed

10 ips (254.0 mm/sec)	8 ips (203.2 mm/sec)	6 ips (152.4 mm/sec)
--------------------------	-------------------------	-------------------------

Print Area

Maximum Width

4.1" (104.0 mm)

Maximum Length (Continuous Mode)

98.43" (2500.0 mm)	59.06" (1500.0 mm)	15.75" (400.0 mm)
-----------------------	-----------------------	----------------------

Mode

Continuous, Tear-off, Cutter, Dispense, Linerless

MEDIA SPECIFICATIONS

Sensor Type

Adjustable Transmissive Sensor for Gap,
Adjustable Reflective Sensor for Black Mark,
Paper End, Ribbon Near-End/End

Media Type

Roll (Continuous, Die-cut, Linerless), Fan-fold,
Tag, Ticket

Media

Width (With Liner)

0.98" (25.0 mm) - 5.15" (131.0 mm)

Minimum Length (With Liner)

Continuous 0.35" (9 mm)	Tear-off/Cutter 0.79" (20 mm)	Dispenser 1.18" (30 mm)
----------------------------	----------------------------------	----------------------------

Thickness (Label & Liner)

0.002" (0.060 mm) - 0.011" (0.268 mm)

Roll Diameter

8" (203.2 mm) on 3" (76.0 mm) ID Core
Optional 10" OD (254.0 mm)

Wind

Face-in/Face-out, No Setting Change Required

Ribbon

Width

1.55" (39.5 mm) - 5.04" (128.0 mm)

Length

1,968.5 ft (600 m) on 1" (25.4 mm) ID Core

Roll Diameter

Maximum 3.54" (90.0 mm)

Wind

Face-in/Face-out, No Setting Change Required

SATO Genuine Consumables

For maximum print quality and optimum use, SATO recommends the use of SATO genuine consumables.

MEMORY & PROCESSING SPECIFICATIONS

Dual CPU

CPU1: 2GB Flash, 256MB RAM
CPU2: 4MB Flash, 64 MB RAM

USER FRIENDLY SUPPORT TOOLS

Large Status LED

Blue/Red

Audible Alerts

Adjustable Volume Setting

Self Diagnosis

Head Check, Cutter-Cover Open,
Stand-by Mode, Auto-Calibration

Display Panel

3.5" Full Color LCD

Tool-less Maintenance

Print Head Replacement and Adjustment,
Platen Replacement

Multi-national Language Support

47 Languages Scalable Fonts for Print
31 Languages for LCD Menu

Operation Video

Multiple Instructional Videos On-board
(e.g. Error Resolution, Media Loading, Parts
Replacement and Cleaning)

Emulation

Auto Detect - SBPL®, SZPL®, SDPL®, SIPL® or
STCL® (Pre-installed)

Remote Maintenance

SNMP Ver. 3, HTTPS

COMMUNICATION INTERFACES SPECIFICATIONS

Standard

USB 2.0 (Type A, Type B), Ethernet (IPv4/IPv6)
on Rear Panel, USB 2.0 (Type A) on Front
Panel, RS-232C, IEEE1284, EXT on Standard
Interface Board, Bluetooth® Ver. 3.0

Optional Wireless LAN Kit (Internal)

Wi-Fi®, Wi-Fi Direct® and CCX (Cisco®) Version
4 Certified, IEEE 802.11 a/b/g/n, Dual Band
(2.4 GHz, 5 GHz)

OPTIONS

Cutter, Linerless Cutter Kit, Dispenser with
Internal Liner Rewinder, Real-time Clock, UHF
RFID (ISO18000-6 Type C), W-LAN Kit

FONT SPECIFICATIONS

Internal Fonts

10 Bitmap SATO Fonts, 15 Scalable SATO
Fonts, Multi-National Language Support (47
Languages/Unicode), Single and Double Byte
Fonts (Korean, Chinese, Japanese)

BARCODE SYBLOGIES SPECIFICATIONS

Barcodes

Linear

Code 39, Code 93, Code 128,
CODABAR (NW7), EAN8/13,
GS1-Databar™, GS1-128 (UCC/EAN128),
Interleaved 2/5, Industrial 2/5, JAN 8/13,
Matrix 2/5, MS1, Bookland,
Postnet™, UPC-A/E

2D Sybologies

PDF417, Micro PDF, Maxi Code, GS1 Data
Matrix, QR Code, Micro QR Code and
Composite Sybologies

User Downloadable Fonts, Graphics or Format

Maximum 100MB

OPERATING & ENVIRONMENT CHARACTERISTICS

Electrical Requirements

Universal Auto-ranging Power Supply,
100-240VAC +/- 10%, 50/60Hz
Energy Star - Compliant

Standards & Agency Approvals

IEC 60950, CE Marking, EN 60950-1, EN
55022 Class A, EN 55024, R&TTE, NEMKO-
GS, cMETus, UL60950-1/CSA C22.2 No.
60950-1, FCC 15 (SUB B, C), ICES-003, NMB-
003, BIS, C-Tick, RCM, CCC, SRRC, KC,
S-Mark (Arg), SIRIM, IDA, PTQC, NBTC

Environment

Operating

32 to 104°F (0 to 40°C), 30-80% RH,
Non-condensing; Linerless: 40 to 95°F
(5 to 35°) 30 - 75% RH, Non-condensing

Storage

-4 to 140°F (-20 to 60°C), 30 - 90% RH,
Non-condensing

PHYSICAL CHARACTERISTICS

Dimensions

Width: 10.67" (271.0 mm)
Depth: 17.99" (457.0 mm)
Height: 12.63" (321.0 mm)

Construction

Die-cast Aluminum
(Base, Frame, Front Cover, Ribbon Spindle,
Print Head Mechanism)

Side-cover

Bi-fold for Space Saving with Large
Clear Window

Secure Mounting

3 Mounting Holes on Chassis for Flat or
Incline Setting

Weight

33.0 lbs. (15.1kg)



För mer information kontakta:
ACT Logimark Sverige AB
Topplocksgatan 3, SE-212 41 MALMÖ
Tel:040-59 76 80 Fax:040-49 76 89
E-post:info@logimark.se
www.logimark.se